

# Designated dormitory requirements of International Christian University 2021

In designated student dormitories, a husband-wife team of dorm managers (dorm mother) are in permanent residence and support everyone's student life. All rooms are single, equipped with basic furniture. Moreover, in most dormitories, well-balanced breakfast and dinners are provided to make it easier and less stressful to start living away from home.

Furthermore, applying for a designated dormitory simultaneously with an ICU dormitory (multiple applications) is available in a limited number of rooms. This is to secure a room in one of the designated dormitories until the screening result for an ICU dormitory is announced. With this system, there will be no concerns about having to look for accommodation at the very last minute.

## Multiple applications for a designated dormitory: The application process

(When applying, please notify Kyoritsu maintenance whether you applied for an ICU dormitory.)

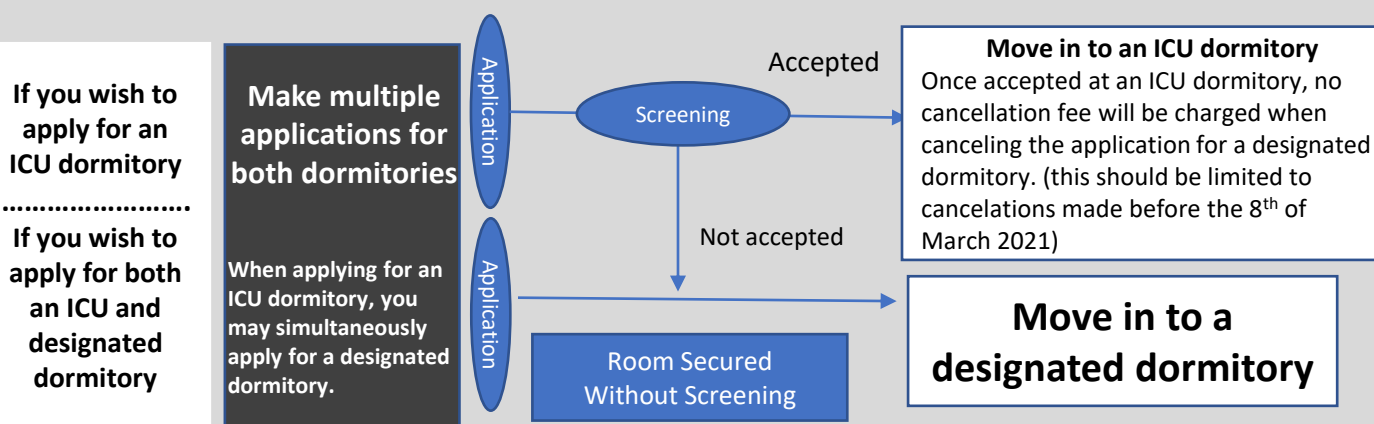

### ◆Process of `Multiple Applications`

Refer to the designated dormitory list on the following page and let us know your top three choices for dormitories via e-mail. We will tell you which dormitory is available when your result of the ICU dormitory is confirmed. Please make sure to tell us its result.

Those who apply for `Multiple Applications` take a room of designated dormitory preferentially.

### ◆ Common facilities and equipment in designated dormitories

<Private Room Equipment> : bed, desk, chair, air-conditioner, closet, bookshelf, curtains, lighting fixture, desk lamp, Internet antenna terminal (bedding lease is available if you do not bring your own.)

<Public Area Facilities>: dining room, laundry room (free washing machines), kitchen, communal bath, shower room, fire-prevention, equipment, fire-fighting equipment, broadcast equipment.

<Shared Equipment>: TV, irons, vacuum cleaners, microwave ovens, refrigerator, etc.

<Meals>: Homemade and well-balanced meals are served. You can choose one from Japanese or Western menu for breakfast. \*Meals are not served in all dormitories.

## Inquiry and application contract for designated student dormitories



◆ Designated dormitory

Name of dorm	Male/ Female	From the nearest station (by walk)	Type	Commuting time
Dormy Musashisakai2	Male/ Female	From JR Chuo Line Musashisakai Sta 7min	C ※	About 12 minutes by bicycle
Share House Dormy Musashisakai	Female	From JR Chuo Line Musashisakai Sta 16min	A	About 12 minutes by bicycle
Dormy Fuchushiraitodai	Female	From Seibutamagawa Line Shiraitodai Sta 10min	A	About 20 minutes by bicycle
Dormy Koganei	Female	From JR Chuo Line Musashikoganei Sta 12min	A	About 16 minutes by bicycle
Dormy Nishiogikubo	Female	From JR Chuo Line Nishiogikubo Sta 9min	C	About 30 minutes
Dormy Higashikoganei2	Male	From JR Chuo Line Higashikoganei Sta 13min	A	About 12 minutes by bicycle
Dormy Fuchu CH	Male/ Female	From Seibutamagawa Line Tama Sta 10min	B	About 15 minutes by bicycle

※Share kitchen

Three types of room

**Type-A**

Spacious room.  
No need to clean sink or washbasin.

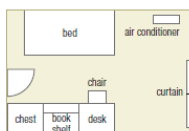

**Type-B**

Washstand-equipped room is convenient for dressing in the morning

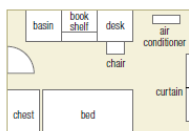

**Type-C**

Fully equipped room, with bathroom and kitchen

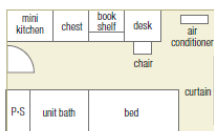

Plan 1

Long-term stay plan for foreign students. (90 days or more) **¥74,800**~/month

	Type-A	Type-B	Type-C	Initial cost
Dormitory fee (with meals)	¥66,200	¥71,200	¥101,200	Admission fee <sup>※1</sup> ¥50,000
Electricity Fee (tax excluded)	¥5,000	¥5,000	¥5,000	Security deposit <sup>※1</sup> ¥50,000
Internet Facility Fee <sup>※</sup> (tax excluded)	¥3,600	¥3,600	¥3,600	Building Maintenance Fee <sup>※2</sup> ¥3,000
Total	¥74,800	¥79,800	¥109,800	Total ¥103,000
				[ Room Cleaning Fee -----¥33,000~¥43,000 ]

※:universal service fee\* is added to internet facility fee. Payment will be requested on be half of the telecommunications operator.

※1: The security deposit will be refunded at the end of a contract.  
※2: Charged yearly

We are thoroughly taking countermeasures against the covid-19!  
No clusters have occurred.

infection prevention at a common area (example)



Disinfect high-touch surfaces for instance, door handles, elevator button



During cleaning work, constant wearing of masks and gloves

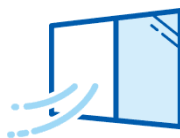

Regular ventilation



To prevent droplet infection, install counter sneeze guard

